

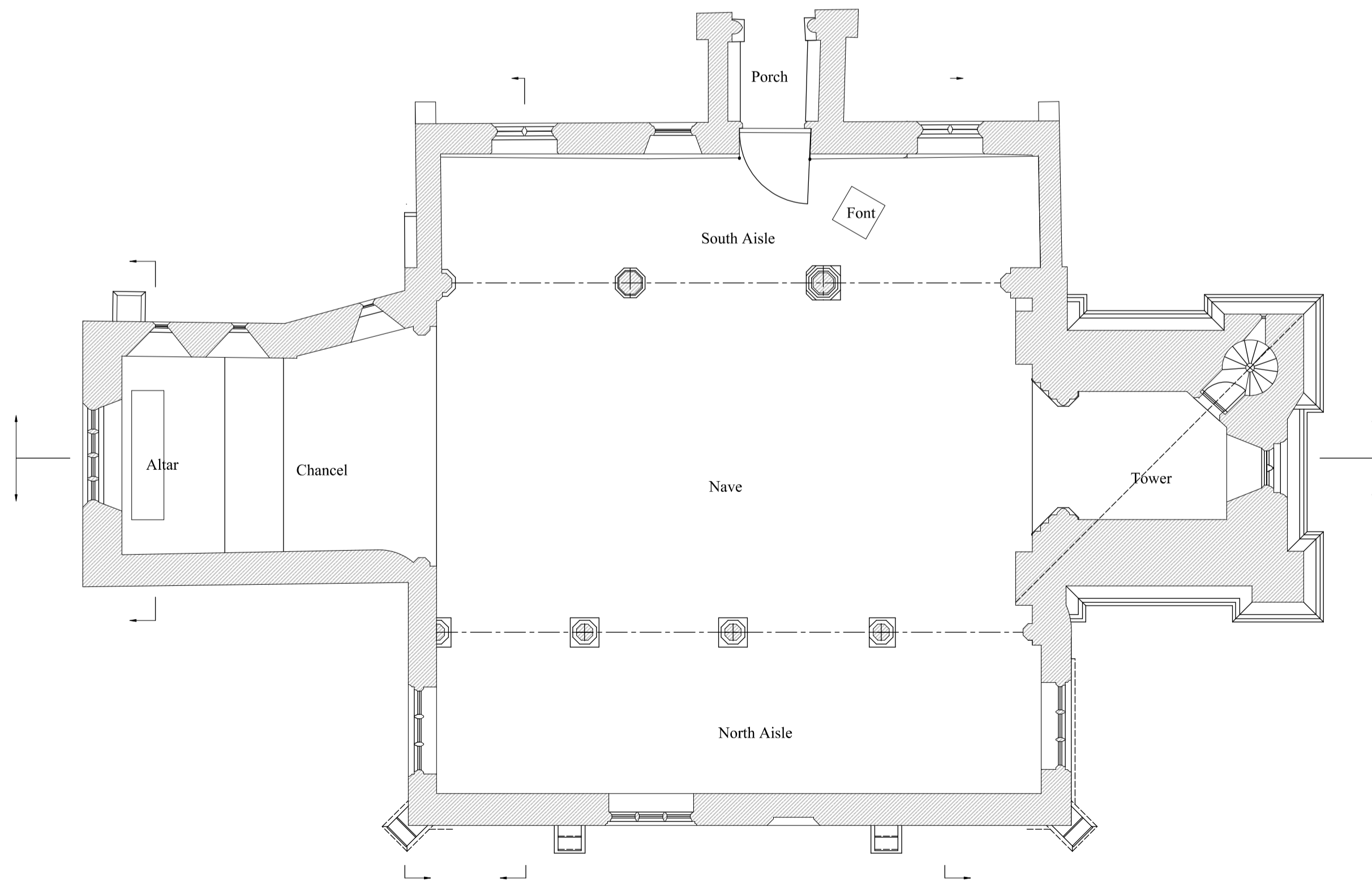

Section C, looking East through Nave 1:100



East Elevation 1:100



Ground Floor Plan 1:100

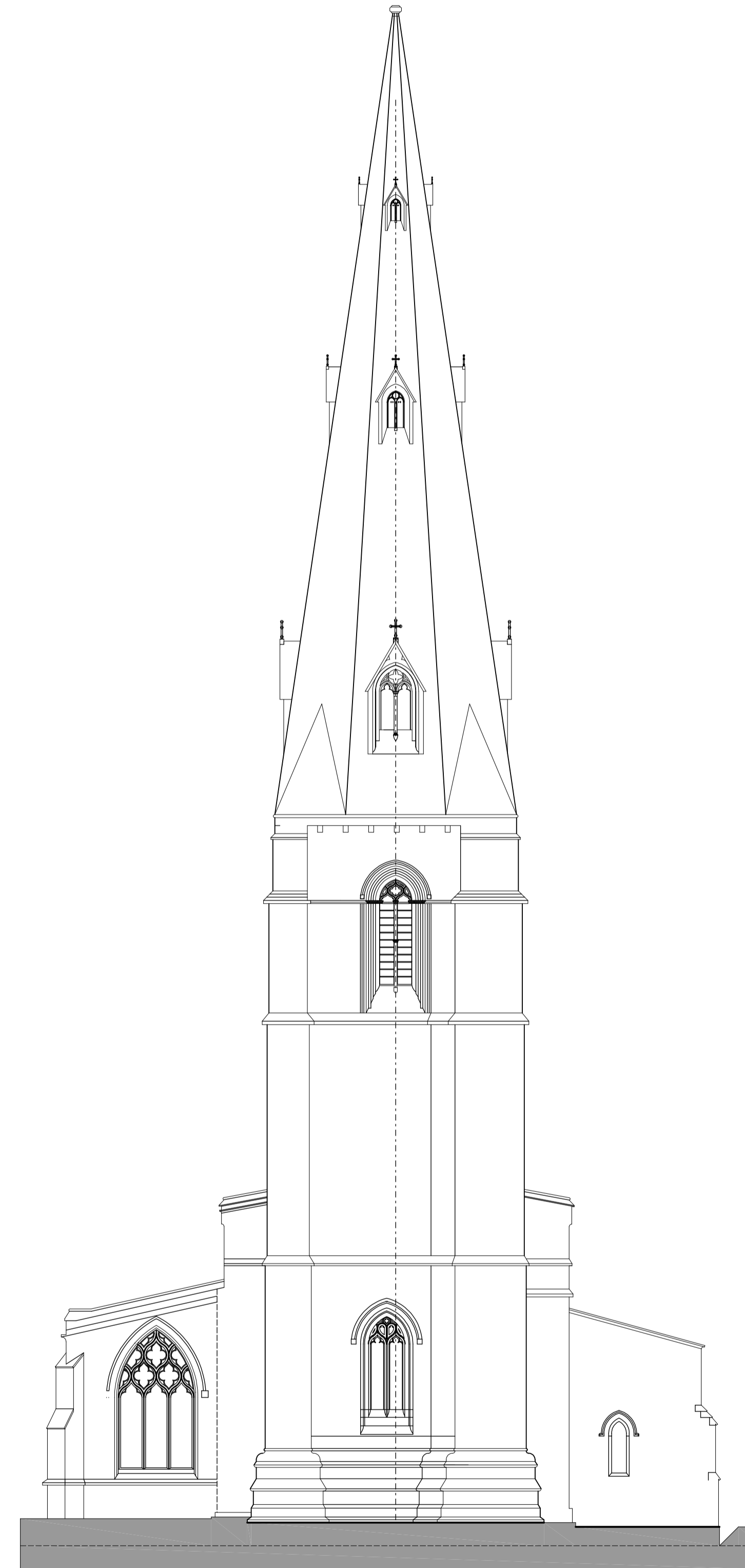

West Elevation 1:100

This drawing should be read with Sheets 2 & 3 (628/12/S1 4 & 15), showing the Church after completion of the 14th Century works.

Development Note -  
Please note that this drawing shows the development of the drawn record at the date above. The drawing is still not complete, as certain information requires to be updated in terms of the on site measure at this time, and so this is a record of the work in progress, for assessment.

© McCombie Smith Architects



McCombie Smith Architects  
12 Church Lane . Greetham . Rutland . LE15 7NF  
Tel 01572 812808 Fax 01572 812466

Greetham Church  
1370  
Sheet 1

SCALE 1:100 on A1  
DATE March 2013  
DRAWN AS

628/12/S13